

Roof Cowls and Terminals

TERMINATOR COWLS DIMENSIONS (mm)

To provide a weatherproof route for supply & exhaust air to your ducted system.

Cowls are manufactured from flame retardant polymer and can be supplied with gravity backdraught shutters, bird guards and hand guards. The terminal is finished in BS00A05 Grey as standard. All BS or RAL colours are available. The cowl will normally be fitted to the upstand by a roofing contractor or builder. The Cowl can be fitted without shutters on a 0-60 degree pitched roof with its longer side running down the roof slope. The Cowl can be fitted with its longer side running across a slope of less than 85 degrees from the horizontal. When fitted to a wall the longer side must run horizontal.

Typical code: TRTS-A Note: S = Shutters

Note: Air Pressure Drop of Cowl (Pa) = Z x Q²

where Z = Factor listed in table below Q = Air Volume Flow Rate (m³/s)

Code	A	B	C	D	E	Weight Kg	Z Extract	Z Intake
TRTS-A	900	620	340	460	600	12.3	67	118
TRTS-B	1080	740	375	560	695	14.7	39	87
TRTS-C	1320	964	475	700	945	26.0	28	62
TRTS-D	1470	1076	490	800	1050	28.2	19	32
TRTS-E	1780	1170	485	900	1136	50.0	7	11.3
TRTS-F	2260	1476	600	1200	1452	88.0	2.5	3.6

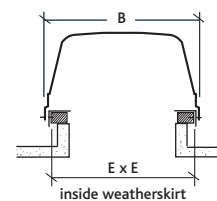
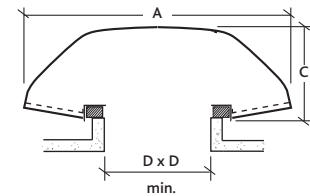

SUPPLY/EXTRACT COWLS DIMENSIONS (mm)

Supply/Extract Cowl: rigid flame retardant cowl, conforming with BS476 (Part 1 class 11) supplied in grey (BS 00 A 05) as standard (any BS or RAL colours available), fixing directly to the base using non-rusting sealed fixings. Air plenum is manufactured from galvanised steel incorporating supply & extract chambers. Rigid spigots are provided for connection of duct work. Supply & extract chamber is fitted with a bird guard.

Typical code: TRSE1

Code	A	B	C	D	E	F	G	Weight Kg
TRSE1	900	620	340	460	600	200	100	14
TRSE2	900	620	340	460	600	200	125	14
TRSE3	900	620	340	460	600	200	150	14
TRSE4	1320	964	475	700	945	345	200	30
TRSE5	1320	964	475	700	945	345	250	30
TRSE6	1320	964	475	700	945	345	315	30
TRSE7	1780	1170	489	900	1150	450	400	57

Resistance to airflow of this item is negligible.

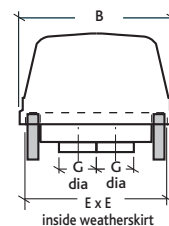
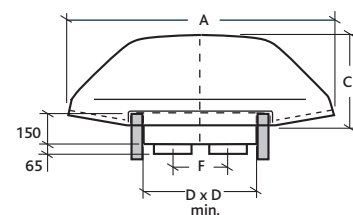

Roof Cowls and Terminals cont.

FILTERED TERMINALS DIMENSIONS (mm)

Low profile terminals are to be supplied by Nuair. The terminal is to be rectangular, constructed in aluminium alloy and with non-rusting fixings. Twin inlets fitted with inlet/bird guards and an integral weather skirt. Filtered units are to be fitted with filter frames for removal and replacement of BS2831 and BS2963 filters.

Typical code: 630LPDT/1 - Disposable Filter. 630LPWT/1 - Washable Filter.

Code	A	B	C	D	Weight Kg	Z Extract	Z Intake
630LP*T/1	1350	700	272	690	15.1	67	106
800LP*T/1	1364	800	324	790	25.2	51	88
1000LP*T/1	1802	1050	418	1040	32.5	18	28
1120LP*T/1	2063	1150	476	1140	41.1	17	35
1250LP*T/1	2204	1250	532	1240	45.0	9	16
1400LP*T/1	2620	1820	600	1440	91.0	3.3	6.5

Note: * D = Disposable * W= Washable

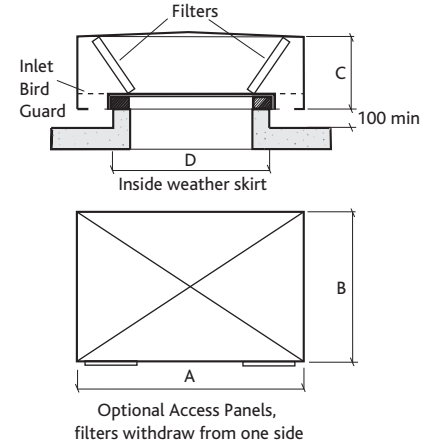

NON-FILTERED TERMINALS (mm)

Low profile terminals are to be supplied by Nuair. The terminal is to be rectangular, constructed in aluminium alloy and with non-rusting fixings. Twin inlets fitted with inlet/bird guards and an integral weather skirt.

Typical code: 315LPT/1

Note: Air Pressure Drop of Attenuator (Pa) = Z x Q²

where: Z = Factor listed in table below Q = Air Volume Flow Rate (m³/s)

Code	A	B	C	D	Weight Kg	Z Extract	Z Intake
315LPT/1	615	400	150	390	3.5	553	614
400LPT/1	745	500	165	490	5.8	222	296
500LPT/1	915	600	200	590	8.1	105	117
630LPT/1	1355	700	280	690	12.6	48	29
800LPT/1	1390	800	350	790	23.5	32	21
1000LPT/1	1820	1050	420	1040	29.8	13	10
1120LPT/1	2070	1150	500	1140	35.0	6.5	4.6
1250LPT/1	2215	1250	540	1240	41.0	5	4
1400LPT/1	2650	1820	600	1440	65.0	1	1

