

Genie M 230V

Duct Mounted Toilet and Bathroom Fans

Installation and Maintenance

CE EC DECLARATION OF CONFORMITY
 We declare that this type Genie Fan conforms to:
 89/336/EEC
 73/23/EEC

Introduction

The Genie-M range of duct mounted fans has been specifically designed to serve small rooms such as toilet, bathroom and cloakrooms.

The fan is to be mounted in ductwork and is suitable for location inside or outside the area served. 100mm inlet and outlet spigots are fitted for connection to suitable ductwork and a 1.5mtr length of electrical lead is included so as to ease the electrical installation.

Units available are:

GENIE-M Standard unit

GENIE-MS With integral run on timer

GENIE-MX Two speed fan, trickle and boost.

See catalogue page 199 for dimensional detail and page 209 for a selection of optional ancillaries including grilles and ductwork.

Installation

The installation must be completed by competent persons in accordance with good industry practice and should conform to all governing and statutory bodies i.e. IEE, CIBSE, COHSE, HVCA etc.

Mechanical installation

Having installed the associated ductwork and the electrical supply, prepare a non-reverberant mounting position for the fan. Offer the universal-mounting bracket to the white coloured half of the unit with the three self tapping screws provided, this half of the case contains the fan assembly and from where the electrical connection exits the case.

Connect the ductwork and secure the bracket to the prepared surface.

Figure 2. Horizontal and vertical airflow.

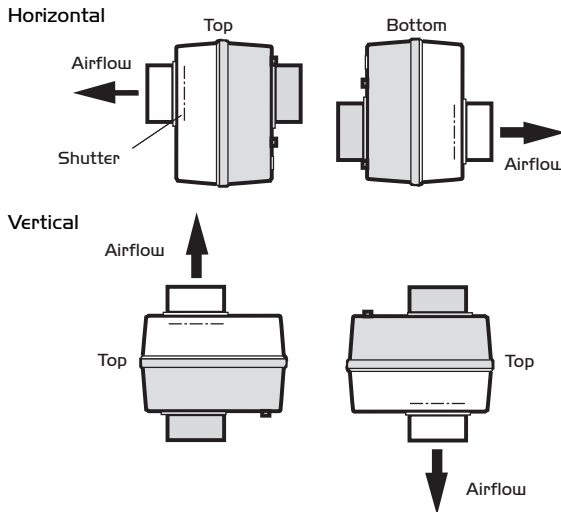
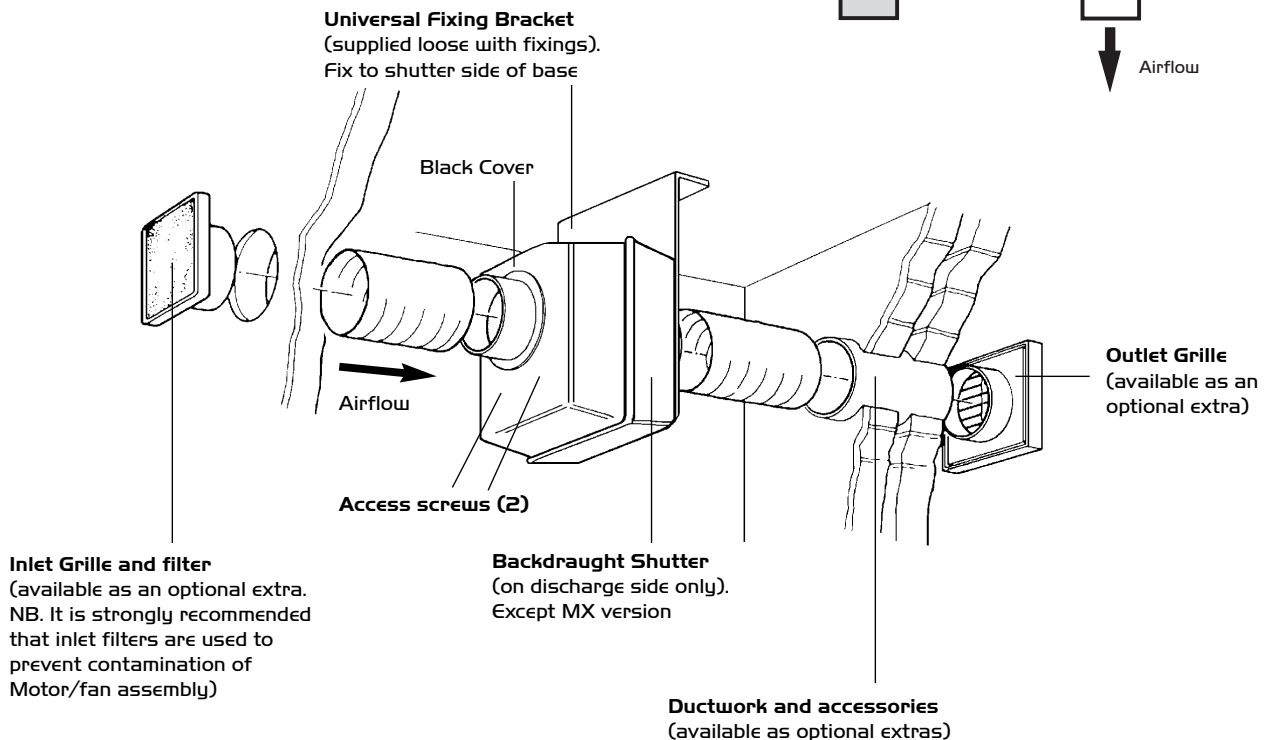

Figure 1. Typical installation arrangement.



Nuaire Home Ventilation Western Industrial Estate Caerphilly United Kingdom CF83 1NA
 Telephone: 08705 002555 Facsimile: 08705 002666
 Email: info@nuaire.co.uk www.nuaire.co.uk

Isolation - Before commencing work make sure that the unit is electrically isolated from the mains supply.

Electrical installation

All units are supplied with a 1.5Mtre length of cable connected to the fan, to ease installation without having to part the case and to facilitate connection to a fixed electrical supply, via appropriate switched/fused spur.

Wiring details

Wire coding: Live = L
Neutral = N
Switched live = 2
Earth = \perp

Figure 3. Genie M.

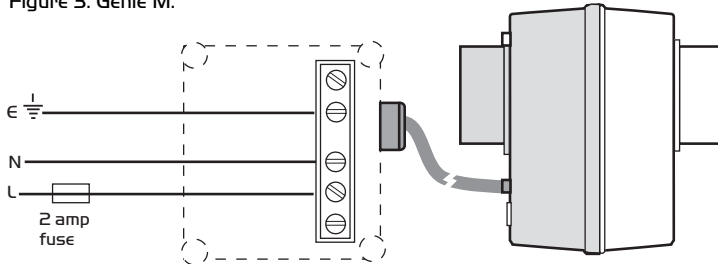
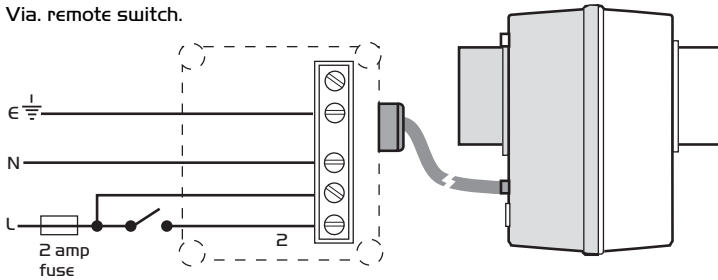

Figure 4. Genie MS and Genie MX. Via. remote switch.



Setting to work

Upon completion of installation switch the mains supply on.

The GENIE-M will run continuously when 230V is presented to the brown wire.

Figure 5. Adjusting the overrun time (only the Genie-MS).

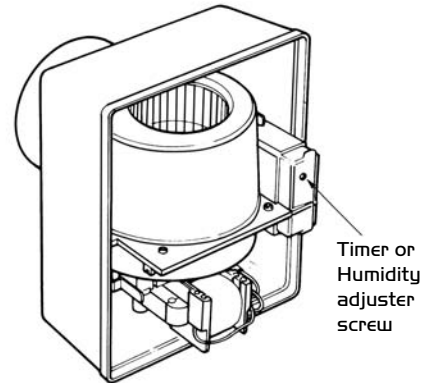

The Genie-MS will activate only when 230V is presented to the brown wire and 230V is presented to the black wire (Via light switch, door switch, humidistat etc).

The Genie-MX will activate only on trickle speed when 230V is presented to the brown wire but will boost to high speed when 230V is additionally presented to the black wire (via light switch, door switch, humidistat etc.)

Maintenance

General

Dust, fluff etc. if allowed to build up on the motor and impellers will effect the efficiency of the fan, shortening the working life and, in severe cases lead to overheating of the motors. It is therefore strongly recommended that all units are fitted with inlet filters at the grilles to prevent contamination, the unit should also be inspected and cleaned at least every six months.

Procedure

Before carrying out any work, isolate the unit from the mains supply.

At all times take care not to damage, distort or disturb the balance of the impeller. Remove the electronic control module. Spring aside the two clips and remove the fan module Inspect and replace any damaged items.

Using a soft brush or dry cloth remove dust and dirt from the fan module. Wash cover in warm soapy water and dry thoroughly. Re-fit fan and electronic control module, replace front cover and secure with screws. Wash grille filter in tepid water to which a little mild detergent has been added. Shake out excess water and allow to dry naturally. Replace filter.

Replacement of Parts

Should any component need replacing Nuair keep extensive stocks for quick delivery. Ensure that the unit is electrically isolated, before carrying out any work.

When ordering spare parts, please quote the serial number of the unit and the ARC number of the purchase if possible.

(This information will be available on the fan label).

3 Year Warranty

The 3 year warranty starts from the day of delivery and includes parts and labour for the first year.

The remaining 2 years covers replacement parts only. This warranty is conditional on planned maintenance being undertaken.

Service Enquiries

Nuair can assist you in all aspects of service. Our service department will be happy to provide any assistance required, initially by telephone and If necessary arrange for an engineer to call.

**Customer Services Department
on 08705 002 555**

Technical or commercial considerations may, from time to time, make it necessary to alter the design, performance and dimensions of equipment and the right is reserved to make such changes without prior notice.